

CONSTRUCTION PROJECT OF NEW DORMITORY BUILDING AND STAFF QUARTERS AT AASHRAM SHALA, SONVADA

Name of Project: Aashram Shala, Sonvada

Time period for the Project: 240 DAYS from starting of work

Estimated Required Funds: \$170,460.00

Funding Breakdown:

- 1) **\$17,046** before starting Project
(If we start project 1st May 2019)
- 2) **\$42,615** on 1st July 2019
- 3) **\$42,615** on 1st Sep 2019
- 4) **\$42,615** on 1st Nov 2019
- 5) Final Payment of **\$25,569** on or before January 1, 2019

Number of students in school till date: 210 students

If we calculate life span of building of 25 years and if average 210 students per year utilize this building than, we are spending **\$32.46 per student** .

Current Status:

Following are some reasons the Dormitory Building needs to be constructed immediately:

- Due to old cement sheets in roof, huge amounts of water leaks from the roof in addition there is ground water seepage from floor into rooms of existing structure converting them into ponds during monsoon season.
- Some parts of roof are collapsed due to decay of roof supporting structure (wooden frames) & due to that, the building was abandoned due to danger of collapse.
- Walls, doors & windows are deteriorated due to water leakage leaving them unusable.
- There are no basic necessities like lights & fans.
- As students are using classrooms as dormitory room in night, there is no beds & students forcefully sleep on to floor.

Building Impact:

- We can accommodate 210 students in new building.
- There will be good light, ventilation & a healthy environment.
- There will be separate & hygienic toilet blocks for boys & girls.
- The students will have bunk beds and individual storage space with their lockers.
- With higher living standard the students will be healthier and motivated with their studies.
- The students from tribal societies will be encouraged to attend school.

Brief about school:

- Administrated by: Halpati Seva Sangh,
 - Kamgar Ghar,
 - Sardar Baug,
 - Bardoli.
- Name of school: Ashram Shala Sonvada, Sonvada.
- Established: 1969.
- President of HSS: Dr. Arvindbhai Desai
- Secretary of HSS: Mr. Manoj Desai
- Principal of Ashramshala: Mr. Nareshbhai Patel (M.A. B.Ed.)
- Staff of Ashramshala:
 - Mr. Balkrishna Tandel (A.T.D.)
 - Mr. Rajendra Desai (M.Sc. B.Ed.)
 - Mrs. Kalpanaben Patel (M.A. B.Ed.)
- Grades: 1 to 8
- Numbers of students: 210 (will be 240 in near future)
 - Approxametely 109 boys & 101 girls
- License no of school: No-3 ASB-65-66-2005 Dated: 07/06/1965

Different Activities done besides education:

- (1) Sports Programs
- (2) Exam of Hindi exam held by Gujarat vidyapith
- (3) Exam of Gandhi vichar exam held by Gujarat vidyapith
- (4) Elocution competition on Gandhi vichar held by maitree trust
- (5) Training of rangoli
- (6) Best out of waste
- (7) Drawing competition
- (8) Hair style competition
- (9) Fancy dress competition
- (10) Mono acting competition
- (11) Elocution competition on swami vivekanand
- (12) General Knowledge
- (13) Essay writing competition
- (14) Handwriting competition
- (15) Field trips of various locations
- (16) Cultural activities

POTENTIAL PHASE -2

CONSTRUCTION OF 6 STAFF QUARTERS

Construction of 6 quarters for teachers & staff

2580 SQ.FT. X \$12 = \$30,960 USD

NOTE : Phase -2 is not yet on board & not started with dormitory building

Following few pics of old facilities:













Following will be proposed Dormitory Building:

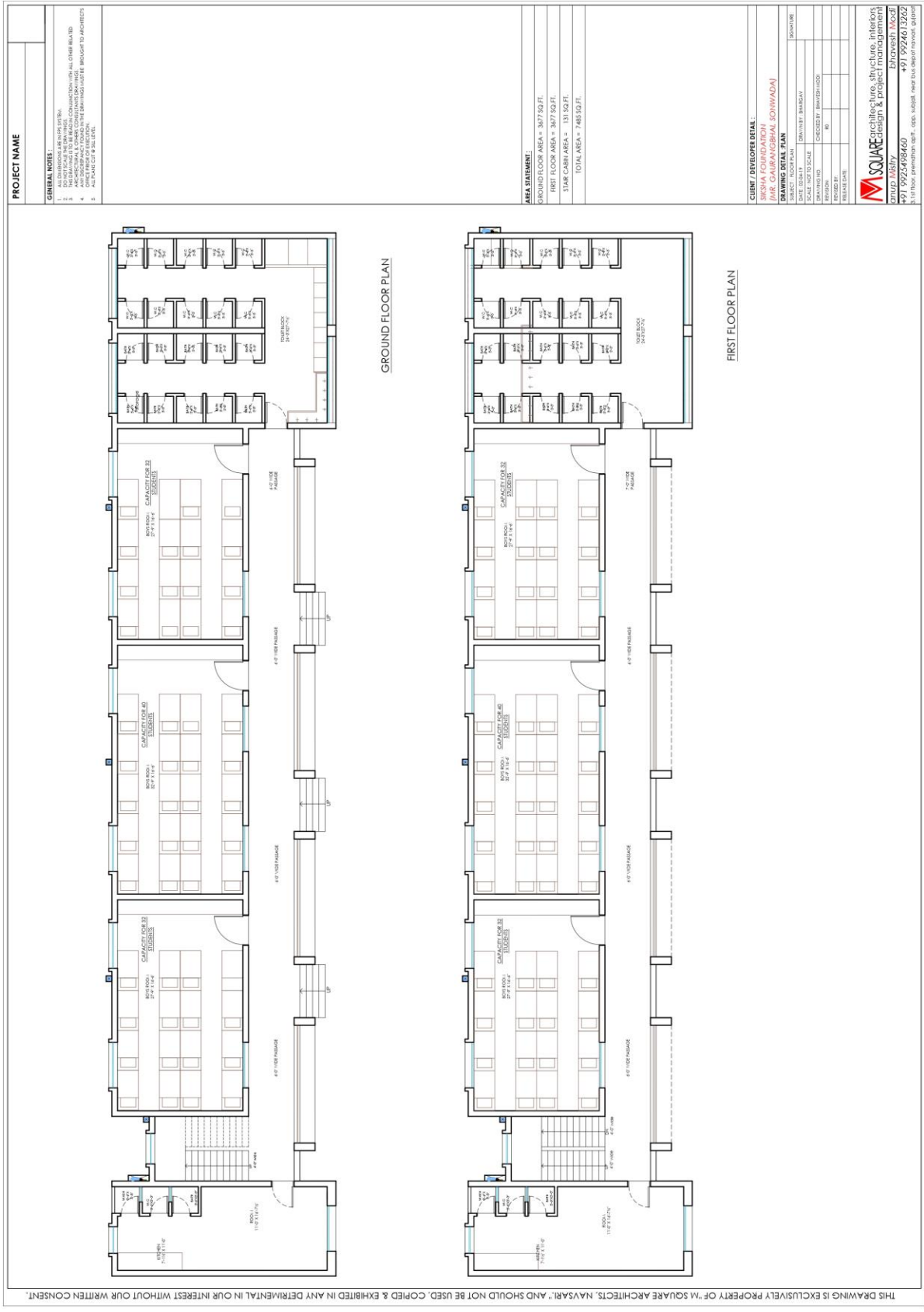

M SQUARE Architecture, structure, interiors
design & project management

Plot No. 10, Sector 10, Vashi, Navi Mumbai
+91 9923498460 +91 9924613262

Chavesh Modi





Followings are few pics of Actual work on Site:



GROUND BREAKING CEREMONY



GROUND BREAKING CEREMONY



DEMOLITION OF OLD STRUCTURE



ALIGNING BUILDING ON GROUND





DIGGING FOR FOUNDATIONS





CASTING OF FOUNDATION





CASTING COLUMN ABOVE FOUNDATION



CASTING OF GROUND BEAMS



BRICK MASONRY FOR PLINTH



GROUND BEAM ON PLINTH





SITE VISIT BY SIKSHA EXECUTIVE



PREPARATIONS FOR PCC





CASTING OF PCC



CASTING OF COLUMNS



BRICK WORK FOR GROUND FLOOR



SHUTTERING TO CAST SLAB